

Industrial Cleaning Catalog

Hoses, Fittings & Accessories



Industrial Cleaning

Hoses, Fittings, & Assemblies



Expert Assemblies for Industrial Cleaning

JGB® Enterprises has been a leading supplier of hose, fittings, and hose assemblies for the **Industrial Cleaning** market since 1977. Our assemblies service pressure washing, waterjetting, waterblasting, sandblasting and so many more sectors involved in industrial cleaning.

JGB is also a member of the WJTA - WaterJet Technology Association.

We have the largest Industrial Cleaning hose inventory, so we can provide just in time solutions in an effort to reduce unnecessary down time. Our multiple locations can provide in field technical support, and assure timely delivery of your assemblies.

Table Of Contents

Waterblast Hoses & Accessories	- 1
Thermoplastic Waterblast Hose Assemblies	- 5
Pressure Washer Hose Assemblies	- 10
Suction Hose	- 12
Petroleum Hose Solutions	- 15
Material Handling Hose	- 19
Discharge Hose	- 22
Sandblast Hose & Assemblies	- 24
LDH Hose	- 25
UHMWPE Chemical Hose & Assemblies	- 27
Red Air Hose Assemblies	- 28
Contractor's Water Hose and Assemblies	- 29
Yellow Air Hose (BULL HOSE)	- 30
Sewer Cleaning Hose Assemblies	- 31
Steam Hose & Assemblies	- 33

Table Of Contents

Universal Couplings (For Air & Water Service Only) - 36

Vacuum Hose Couplings - 37

Cam & Groove Couplings - 38

Cam & Groove Accessories - 39

Shank Hose Couplings - 40

Powerlock Clamps - 40

Hose Menders - 40

Hammer Unions - 41

Sandblast Hose Couplings - 42

Fire Hose Couplings - 43

Hose Banding Tools (Center Punch) - 44

Safety Cables - 45

Hose Safety Accessories - 46

Additional Resources - 47

Waterblast Hoses & Accessories

Eagle Water Jetting Hose

Used for stripping layers from hard surfaces, strip mining, and washdown applications.



Application: Stripping layers from hard surfaces, strip mining and washdown applications.

Tube: NBR/SBR, light oil resistant

Reinforcement: 2-1/2" - 4": 6 ply

6": 8 ply

High tensile textile cord

Cover: NR, Weather, Ozone, and Abrasion Resistance

Temperature: -22°F to +185°F

Branding: EAGLE WATER JETTING

Couplings: Contact JGB for proper fitting recommendation and coupling procedure.

Part #	ID	Wall	WP	Burst	Weight
	in	mm	psi	psi	lbs/ft
004-0480-0800I	3	11	800	2400	2.5
004-0640-0800I	4	13	800	2400	3.7
004-0960-0600I	6	14	600	1800	5.6



Dunlop Hiflex Waterblast Hose

Designed for very high pressure waterblasting.



Application: Stripping layers from hard surfaces, strip mining and washdown applications.

Tube: NBR (Nitrile Rubber)

Reinforcement: 4 Spiral Layers

Cover: NBR (Nitrile Rubber)

Temperature: -40°F to +160°F

Series	ID	OD	WP	Burst Pressure	Tensile Strength	Bend Radius	Weight
	in	in	psi	psi	lbs	in	lbs/ft
WB10	1/2	0.969	10000	25000	2976	8.00	0.61
WB10	3/4	1.27	10000	25000	4452	8.25	0.98
WB10	1	1.528	10000	25000	11034	14.00	1.46

Series	ID	OD	WP	Burst Pressure	Tensile Strength	Bend Radius	Weight
	in	in	psi	psi	lbs	in	lbs/ft
WB15	3/8	0.843	18000	45000	2189	6.00	0.57
WB15	1/2	1.000	16000	40000	3283	8.00	0.85
WB15	3/4	1.252	14500	36250	6373	11.00	1.20

Description: Ultra High Pressure Waterblast Hose

Tube: NBR (Nitrile rubber)

Cover: NBR (Nitrile rubber)

Reinforcement: 6 Spiral

Temperature: -40°F to 160°F

Series	ID	OD	WP	Burst Pressure	Tensile Strength	Bend Radius	Weight
	in	in	psi	psi	lbs	in	lbs/ft
WB20	1/4	0.64	20000	50000		4.92	0.41
WB20	3/8	0.88	20000	50000		5.91	0.69
WB20	1/2	1.16	20000	50000	4178	8.00	1.17
WB20	3/4	1.38	20000	50000		11.81	1.70

Precautions

- Restricted to use as high pressure waterjetting hose where safety factors of 2.5:1 are the industry norm. Due to the safety critical nature of these very high pressure hoses, it is recommended that pre-fitted and tested assemblies are sourced.
- No warranty is given for assemblies made with non-approved fittings.
- JGB recommends referencing the recommended practices for the use of manually operated high pressure waterjetting equipment published by the Waterjet Technology Association (WJTA).

*** Disconnects and Hammer Unions also available

SPIR STAR Hose Type 13/4H



ID13 - Series: B and C

Applications: Waterblast: Heat exchanger tube cleaning, surface preparation (concrete removal, surface cleaning of buildings, paint removal), tank and vessel cleaning, ultra high-pressure waterjet cutting and hydro demolition (cutting and demolition of armoured concrete, pipelines, paper or steel)

Hydraulics: Pressure test equipment (valves, tooling and control panels), hydraulic tools (instrumentation packages for gauges, control of service equipment, hydraulic jacks, hydraulic tools)

Oil and Gas: Grease injection, chemical injection, control of subsea hydraulic components, nitrogen service, Gaseous media handling

Inner Core: Polyamide (PA)

Pressure Support: 4 layers of high-tensile steel wire

Outer Cover: Polyamide (PA)

Temperature: -22°F to 158°F

Colors: Grey

Part #	Nom. ID	OD	Working Pressure	Burst Pressure	Bend Radius	Weight	Insert ID
	in	in	psi	psi	in	lbs/ft	in
H134H050FTMSC	1/2	.87	20.300	50.750	7.87	0.591	0.30

Sleeve

Part #	Thread	Material	Dimensions (in)			
			A	B	C	Torque
11340232	-	Steel	1.16	2.5	-	-

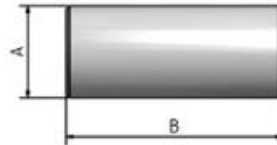

INSERT

HP Fitting

Part #	Thread	Material	Dimensions (mm)			Torque
			A	B	C	
41360214C	9/16"x18UNF LH	Stainless steel	7.5	118	2.4	-

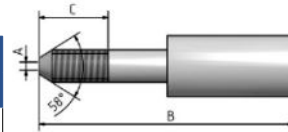

MP Fitting

Part #	Thread	Material	Dimensions (in)			Torque
			A	B	C	
41360204C	3/4"x16UNF LH	Stainless steel	7.5	121	25	-

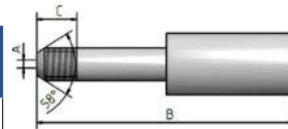

Female swivel 24°/60°

Part #	Thread	Material	Nut	Dimensions (in)			Torque
				A	B	C	
21340314B	G1/2"	Stainless steel	51060315, 51060311	7.5	81	-	27

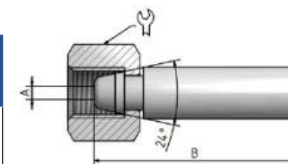

Female swivel with O-Ring

Part #	Thread	Material	Nut	Dimensions (in)			Torque
				A	B	C	
21360244C	M24x1.5	Stainless steel	51320205 51321206	7.5	89	-	32

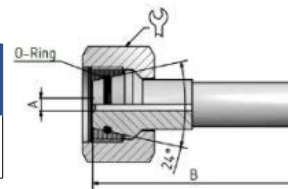

Type M female swivel

Part #	Thread	Material	Nut	Dimensions (in)			Torque
				A	B	C	
21360644C	1"x12UNF	Stainless steel	51360645 51360641 51360643	7.5	84	-	32

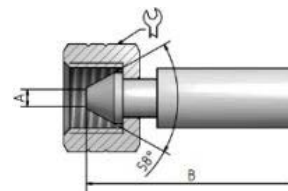

Swivel Nut for Hose Type 13/4H

Part no	Thread	Material	Relief bores	Dimensions (mm)			
				A	B	C	Torque
51360641	1"x12UNF	Steel	1 radial	16.8	28	22	32
51360643	1"x12UNF	Stainless steel	1 radial	16.8	28	22	32
51360645	1"x12UNF	AISI 316Ti	1 radial	16.8	28	22	32
51060311	G1/2"	Steel	1 radial	16.7	23.5	13.5	27
51060315	G1/2"	AISI 316Ti	1 radial	16.7	23.5	13.5	27
51321206	M24x1.5	Steel	2 axial	16.8	23	16	32
51320205	M24x1.5	AISI 316Ti	1 radial	16.8	23	16	32

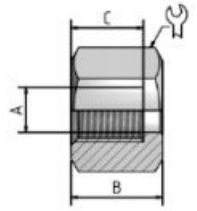

Hose protection without spiral

Part no	Size	Material	Camp Ring
1.903037	ID Ø30, OD Ø39	PVC	1003941
1.903542	ID Ø35, OD Ø42	PVC	-



Hose protection with spiral

Part no	Size	Material	Camp Ring
1.913038	ID Ø30, OD Ø38	PVC	1004145
1.913240	ID Ø32, OD Ø40	PVC	-



Hose securing grip short version

Part #	Mesh length	Overall length	Breaking strength	Suitable for SPIR STAR® hose
	in	in	lbf	outer diameter in
9106400	23.6	31.5	4496, 8992	0.79 - 0.98



ACCESSORIES COMBINATIONS

Without hose protection

Description	Bend Restrictor	Camp Ring	Securing Grips
Securing grip	-	-	9106400

Hose protection without spiral

Description	Protection Hose	Bend Restrictor	Camp Ring	Securing Grips
Protection hose	1.903037	-	1003941	-
with securing grip	1.903542	-	-	9106400

Hose protection without spiral

Description	Protection Hose	Bend Restrictor	Camp Ring	Securing Grips
Protection hose	1.903037	-	1003941	-
with securing grip	1.903542	-	-	9106400

Thermoplastic Waterblast Hose Assemblies

SPIR STAR (Hose Type 5mmUHP®)

Used for surface preparation (concrete removal, surface cleaning of buildings, paint removal), tank and vessel cleaning, ultra high-pressure waterjet cutting and hydro-demolition (cutting and demolition of armoured concrete, pipelines, paper or steel)



ID5 - Series: E

Inner Core: Polyoxymethylene (POM)

Pressure Support: 8 layers of high-tensile steel wire

Outer Cover: Polyamide (PA)

Color: Chrome yellow

Temperature: -22°F to 140°F

Hose

Part #	ID	OD	WP	Burst	Bend Radius	Weight	Insert ID
	in	in	psi	psi	in	lbs/ft	in
5UHP079	0.18	0.60	46.400	116.000	9.84	0.466	0.10

Sleeve

Part #	Material	Dimensions (in)	
		A	B
10580116	Steel	0.776	2.72

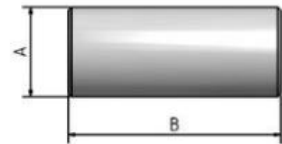

HP Fitting

Part #	Thread	Material	Dimensions (in)		
			A	B	C
40560294E	1/4"x28UNF LH	Stainless steel	2,5	103	14
40560284E	3/8"x24UNF LH	Stainless steel	2,5	112	20
40560264E	9/16"x18UNF LH	Stainless steel	2,5	124	24
40560274E	M14x1,5 LH	Stainless steel	2,5	124	24

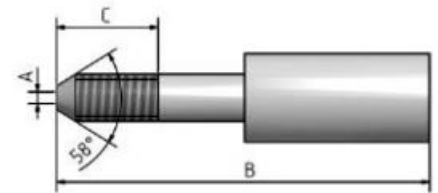

Female Swivel 24°/60°

Part #	Thread	Material	Nut	Dimensions (in)		
				A	B	Torque
20560314E	G1/4"	Stainless steel	50560301	2,5	84	22
20560164E	M14x1,5	Stainless steel	50540101	2,5	84	19

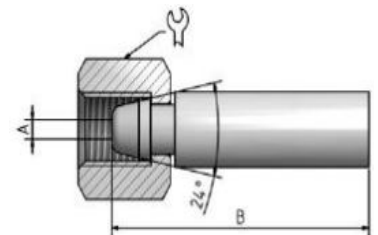

SPIR STAR MAXIMUS (Hose Type 6mmUHP®)

Used for surface preparation (concrete removal, surface cleaning of buildings, paint removal), tank and vessel cleaning.



ID6 - Series: C

- Inner Core:** Polyoxymethylene (POM)
- Pressure Support:** 8 layers of high-tensile steel wire
- Outer Cover:** Polyamide (PA)
- Color:** Chrome yellow
- Temperature:** -22°F to 140°F

Hose

Part #	ID	OD	WP	Burst	Bend Radius	Weight	Insert ID
	in	in	psi	psi	in	lbs/ft	in
6UHP079	0.23	0.73	46.400	116.000	11.02	0.710	0.12

Sleeve

Part #	Material	Dimensions (in)	
		A	B
10680102	Steel	0.933	2.60

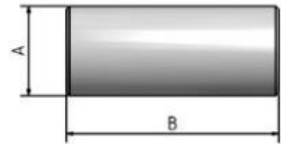

HP Fitting

Part #	Thread	Material	Dimensions (in)		
			A	B	C
40660204C	3/8"x24UNF LH	Stainless steel	0.12	3.86	0.79
40660224C	9/16"x18UNF LH	Stainless steel	0.12	4.41	0.95
40660124C	M14x1,5 LH	Stainless steel	0.12	4.41	0.95

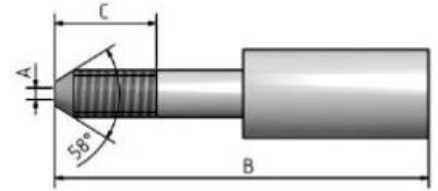

Type M female swivel

Part #	Thread	Material	Nut	Dimensions (in)		
				A	B	Torque
20660604C	9/16"x18UNF	Stainless steel	50560605, 50560601	0.12	2.83	0.87

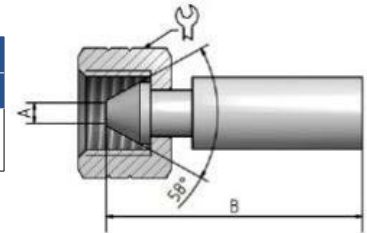

SPIR STAR (Hose Type 8mmUHP®)

Used for surface preparation (concrete removal, surface cleaning of buildings, paint removal), tank and vessel cleaning, ultra-high-pressure waterjet cutting and hydro-demolition (cutting and demolition of armoured concrete, pipelines, paper or steel)



ID8 - Series: C

- Inner Core:** Polyoxymethylene (POM)
- Pressure Support:** 8 layers of high-tensile steel wire
- Outer Cover:** Polyamide (PA)
- Color:** Chrome yellow
- Temperature:** -22°F to 140°F

Hose

Part #	ID	OD	WP	Burst	Bend Radius	Weight	Insert ID
	in	in	psi	psi	in	lbs/ft	in
8UHP079	0.30	0.87	46.400	107.300	11.81	1.005	0.18

Sleeve

Part #	Material	Dimensions (in)	
		A	B
10880142	Steel	2.72	2.60

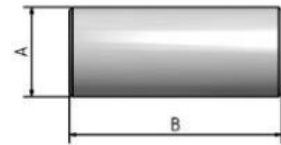

HP Fitting

Part #	Thread	Material	Dimensions (in)		
			A	B	C
40860214C	3/8"x24UNF LH	Stainless steel	0.18	3.94	0.79
40860204C	9/16"x18UNF LH	Stainless steel	0.18	4.4	1.22
40860104C	M14x1,5 LH	Stainless steel	0.18	4.4	0.94

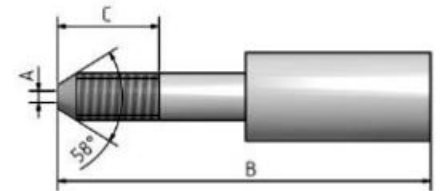

Female Swivel with O-Ring

Part #	Thread	Material	Nut	Dimensions (in)		
				A	B	Torque
20860224C	M24x1,5	Stainless steel	51320205, 51321206	0.18	3.58	1.26

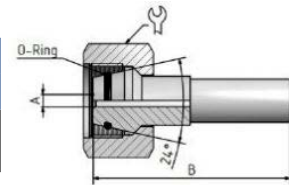

Type M Female Swivel

Part #	Thread	Material	Nut	Dimensions (in)		
				A	B	Torque
20860644C	3/4"x16UNF	Stainless steel	50840605, 50840601	0.18	2.99	0.94

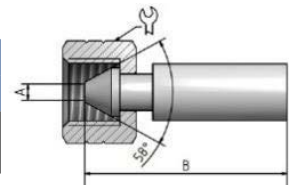

Swivel Nut

Part #	Thread	Material	Relief bores	Dimensions (in)			
				A	B	C	Torque
50840601	3/4"x16UNF	Steel	1 radial	0.48	0.88	0.69	0.94
50840605	3/4"x16UNF	AISI 316Ti	1 radial	0.48	0.88	0.69	0.94
51321206	M24x1,5	Steel	2 axial	0.66	0.90	0.63	1.26
51320205	M24x1,5	AISI 316Ti	1 radial	0.66	0.90	0.63	1.26

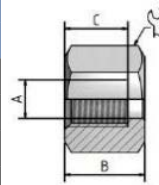

SPIR STAR SILVER MONGOOSE (Hose Type 13/2WR)



Heat exchanger tube cleaning, surface preparation
(concrete removal, surface cleaning of buildings, paint removal)

ID13 - Series: O

- Inner Core:** Polyamide (PA)
- Pressure Support:** 2 open layers, 2 dense layers of high-tensile steel wire
- Outer Cover:** Polyurethane (TPU)
- Color:** Silver
- Temperature:** -22°F to 140°F

Hose Part #	ID	OD	WP	Burst	Bend Radius	Weight	Insert ID
	in	in	psi	psi	in	lbs/ft	in
132WR2281	0.50	0.87	15,080	37,700	5.91	0.395	0.30

Sleeve

Sleeve Part #	Material	Dimensions (in)	
		A	B
11330206WR	Steel	1.08	2.5
11330205WR	AISI 316Ti	1.08	2.36

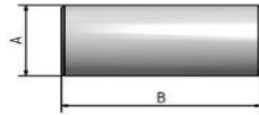

MP Fitting

MP Part #	Thread	Material	Dimensions (in)		
			A	B	C
41360205O	9/16"x18UNF LH	AISI 316Ti	0.30	4.66	0.51

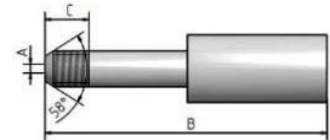

Male fitting

Part #	Thread	Material	Dimensions (in)			
			A	B	C	Torque
31360401O	1/2"x14NPTF	Steel	0.30	3.9	0.71	0.87
31360405O	1/2"x14NPTF	AISI 316Ti	0.30	3.9	0.71	0.87

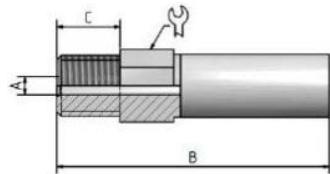

Female Swivel 24°/60°

Part #	Thread	Material	Nut	Dimensions (in)		
				A	B	Torque
21360332O	G1/2"	Steel	51060311	0.29	3.19	1.06
21360335O	G1/2"	AISI 316Ti	51060315	0.29	3.19	1.06

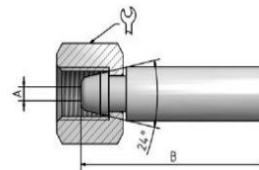

Female Swivel with O-Ring

Part #	Thread	Material	Nut	Dimensions (in)		
				A	B	Torque
21360122O	M22x1,5	Steel	51360221	0.29	3.81	1.18
21360242O	M24x1,5	Steel	51321206	0.29	3.50	1.26
21360245O	M24x1,5	AISI 316Ti	51320205	0.29	3.50	1.26

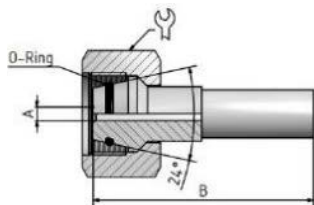

Type M Female Swivel

Part #	Thread	Material	Nut	Dimensions (in)		
				A	B	Torque
21360642O	1"x12UNF	Steel	51360641	0.29	3.31	1.26
21360645O	1"x12UNF	AISI 316Ti	51360645	0.29	3.31	1.26

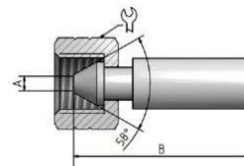

Swivel Nut

Part #	Thread	Material	Relief bores	Dimensions (in)			
				A	B	C	Torque
51360641	1"x12UNF	Steel	1 radial	16,8	1.1	0.87	1.26
51360645	1"x12UNF	AISI 316Ti	1 radial	16,8	1.1	0.87	1.26
51060311	G1/2"	Steel	1 radial	16,7	0.92	0.53	1.06
51060315	G1/2"	AISI 316Ti	1 radial	16,7	0.92	0.53	1.06
51360221	M22x1,5	Steel	1 radial	16,8	0.98	0.55	1.18
51321206	M24x1,5	Steel	2 axial	16,8	0.90	0.63	1.26
51320205	M24x1,5	AISI 316Ti	1 radial	16,8	0.90	0.63	1.26

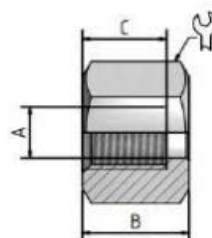

SPIR STAR Blast-Pro Flex Lances (Compact End Fitting for Cleaning Efficiency)

Blast-Pro® flex lances increase cleaning efficiency and reduce lance time by providing you with a larger inner diameter hose with a smaller outer diameter and shorter end fitting. The Blast-Pro® flex lance has a sleeve length 50% shorter than conventional flex lances and increases the maximum outer diameter of the flex lance by only four hundredths of an inch. With the Blast-Pro® flex lance you can clean smaller tubes and pipes with a larger inner diameter hose.



3/4 Blast-Pro (0.13" I.D.)
0.47" Maximum End Fitting O.D.
29,000 P.S.I. Working Pressure
End Fittings: 1/4" - 28 HP Male
Left Hand or Right Hand



4/2H Blast-Pro (0.16" I.D.)
0.39" Maximum End Fitting O.D.
20,000 P.S.I. Working Pressure
End Fittings: 1/4" - 28 MP Male
Left Hand or Right Hand



4/4 Blast-Pro (0.16" I.D.)
0.49" Maximum End Fitting O.D.
31,000 P.S.I. Working Pressure
End Fittings: 1/4" - 28 HP / M or F
Left Hand or Right Hand



5/4 Blast-Pro (0.20" I.D.)
0.49" Maximum End Fitting O.D.
20,000 P.S.I. Working Pressure
End Fittings: 1/4" - 28 OR 3/8" - 24 MP / M or F
Left Hand or Right Hand



6/4 Blast-Pro (0.25" I.D.)
0.57" Maximum End Fitting O.D.
20,000 P.S.I. Working Pressure
End Fittings: 3/8" - 24 MP / M or F
Left Hand or Right Hand



8/4 Blast-Pro (0.32" I.D.)
0.67" Maximum End Fitting O.D.
20,000 P.S.I. Working Pressure
End Fittings: 9/16" - 18 MP / M or F
Left Hand or Right Hand



3/6 Blast-Pro (0.12" I.D.)
0.50" Maximum End Fitting O.D.
40,000 P.S.I. Working Pressure
End Fittings: 1/4" - 28 OR 3/8" - 24 HP Male
Left Hand or Right Hand

Pressure Washer Hose Assemblies

Eaglewash I

For use on pressure washer machines with working pressures up to 4000 psi and temperatures up to 310°F.



- Tube:** Synthetic rubber, resistant against cold and hot water with usual cleaning agents.
- Reinforcement:** One braid of high tensile steel wire.
- Cover:** Abrasion and ozone resistant synthetic rubber, wrapped or smooth.
- Temperature:** 14°F to 310°F
- Packaging:** 500 ft 2 piece reels or cut-to-length coils
- Branding:** 3/8" EAGLEWASH 4001 PRESSURE WASHER HOSE PSI / 310 DEG F #Q##
- Couplings:** Hydraulic 100R1 type crimped to fitting manufacturer specifications
- Colors:** Blue, Gray, Black

Part #			Nom. ID	OD	Bend Radius	Min Burst	Max. Oper. Pressure	Weight
Black	Blue	Grey	in	in	in	psi	psi	lbs/ft
168-6006-3001I	168-0066-4000I	168-0067-4000I	3/8	.59	2.56	12,183	4060	.148

Eagleflex II

Specially designed for use on pressure washer machines with working pressures up to 6000 psi and temperatures up to 310°F



- Tube:** Synthetic rubber, resistant against cold and hot water with usual cleaning agents.
- Reinforcement:** Two braids of high tensile steel wire.
- Cover:** Abrasion and ozone resistant synthetic rubber.
- Temperature:** 14°F to 310°F
- Packaging:** 450 ft 2 piece reels or cut-to-length coils
- Branding:** 3/8" EAGLEFLEX II PRESSURE WASHER HOSE 6000 PSI/310 DEG F #Q##
- Couplings:** Hydraulic 100R1 type crimped to fitting manufacturer specifications
- Colors:** Blue, Gray, Black

Features:

- Available in bulk, 50 ft., 100 ft., and custom lengths
- Lightweight and easy to handle
- A unique cover compound gives JGB Eagleflex II hoses the durability and flexibility to handle abrasion and normal cleaning chemicals used in the wash industry.

Part #			Nom. ID	ID	OD	Bend Radius	Min Burst	Max. Oper. Pressure	Weight
Black	Blue	Grey	in	in	in	in	psi	psi	lbs/ft
172-1006-4002I	172-1006-5801I	172-0067-5400I	3/8	0.4	0.64	2.6	18,274	6090	.255

Eaglewash Carpet Cleaning Hose

Designed for use on pressure washer machines with working pressures up to 3625 psi and temperatures up to 250°F.(300°F Intermittent)



- Tube:** Synthetic rubber, resistant against cold and hot water with usual cleaning agents.
- Reinforcement:** One braid of high tensile steel wire.
- Cover:** Abrasion and ozone resistant synthetic rubber, smooth only.
- Temperature:** -40°F to 250°F (300°F Intermittent)
- Packaging:** 400 ft, 2 piece reels or cut-to-length coils
- Branding:** 1/4" EAGLEWASH I PRESSURE WASHER HOSE 3625 PSI MAX WP INTERMITTENT 300 DEG F #Q##
- Couplings:** Hydraulic 100R1 type crimped to fitting manufacturer specifications
- Colors:** Blue, Gray, Black

Features:

- Available in bulk, 50 ft., 100 ft., and custom lengths
- Lightweight and easy to handle
- A unique cover compound gives JGB Eagleflex II hoses the durability and flexibility to
- Handle abrasion and normal cleaning chemicals used in the wash industry.

Part #			Nom. ID	Nom. OD	Bend Radius	Burst	Max. Oper. Pressure	Weight
Black	Blue	Grey	in	in	in	psi	psi	lb/ft
168-0042-3000I	169-0046-3001I	169-0047-3001I	1/4	0.519	1.38	12,009	3625	.12

Thunderbolt® Hose

Designed for use on either combination machines or pressure washer machines.



- Tube:** Black, heat resistant synthetic rubber
- Reinforcement:** One wire braid
- Cover:** Black heat and oil resistant synthetic rubber RMA class B (pin pricked)
- Temperature:** Handles up to 325°F (163°C) steam at 350 psi with a safety factor in excess of 10 to 1.
Handles up to 250°F (121°C) water at 3000 psi with a 4 to 1 safety factor
- Packaging:** 300 ft reels, multiples of 50 ft max
- Branding:** 3/8" THUNDERBOLT® COMBO 3000 PSI / 250°F - 350 PSI / 325°F
- Couplings:** Recommend testing with hydraulic 100R1 over the wire (Skive hose) fittings crimped to the fitting manufacturer specifications. Compatibility with different over the wire fittings should be tested prior to use.

Features:

- Abrasion-resistant cover prevents wear due to dragging.
- Chemical-resistant inside and out, to handle most of the detergents and chemicals used in industry today.
- High-pressure, one-wire braid takes up to 3000 psi - meeting or exceeding specs for virtually every pressure washer available.
- Ensures worry-free installation in hot, cold or combo applications.
- Available in 50 ft. lengths.

Part #	Nom. ID	Nom. OD	Bend Radius	Min. Burst	Max. Oper. Pressure		Weight
	in	in	in	psi	psi@ 250°F	psi@ 325°F	lbs/ft
171-9006-3000	3/8	.690	2.5	12,000	3000	350	.21

Suction Hose

Eagle Pump® HD 150 PSI

Used for water suction and discharge in industrial and construction services.



Tube: Natural and Synthetic Rubber

Reinforcement: High tensile synthetic textile and steel helix wire

Cover: Abrasion and weather resistant synthetic rubber

Temperature: -22°F to 185°F

Part #	ID	OD	WP	Burst	Bend Radius	Weight
	in	in	psi	psi	in	lbs/ft
004-0242-0150I	1 ½	1.89	150	450	5	0.73
004-0322-0150I	2	2.44	150	450	7	1.2
004-0482-0150I	3	3.5	150	450	12	1.9
004-0642-0150I	4	4.53	150	450	17	2.6
004-0962-0150I	6	6.61	150	450	27	4.9
004-1282-0150I	8	8.86	150	450	43	7.2
004-1602-0150I	10	10.98	150	450	59	12.2
004-1922-0150I	12	12.95	150	450	75	13.79

Eagle Orange/Clear Suction & Discharge Hose

Suction and discharge hose for use in fish suction and rental/construction pumping.

Tube: Smooth Bore, flexible PVC

Reinforcement: Rigid PVC helix, synthetic braiding

Cover: Corrugated O.D.

Temperature: -13°F to 140°F



Features:

- Lightweight and flexible
- Provides anti-static with copper wire
- External helix provides for easy drag
- Rated for both suction & discharge
- Clear sidewall permits visual check of material flow

Part #	ID	OD	Weight	Std. Length	WP	Vacuum Rating	Min Bend Radius
	in	in	lbs/ft	ft	psi	inch HG	inch
007-0240-0100*	1 ½	2.03	0.47	100	110	29	2.5
007-0320-0100I	2	2.6	0.69	100	100	29	4
007-0400-0100*	2 ½	3.01	0.74	100	100	29	5
007-0480-0100I	3	3.7	1.13	100	100	28	6
007-0640-0080I	4	4.78	1.74	100	80	28	7
007-0960-0072I	6	7.17	3.88	20, 60, 100	70	28	10
007-1280-0060I	8	9.34	5.55	20, 25	60	28	16
007-1600-0040I	10	11.63	8.9	20, 25	40	28	25
015-0192-0020I	12	13.66	10.30	20	30	25	45

* Not standard - call for availability.

Eagle EPDM Suction Hose

Designed for liquid waste suction, septic handling, cesspool cleaning, slurries/sludge handling, chemicals, dry material, grain transfer, mining and marine use.

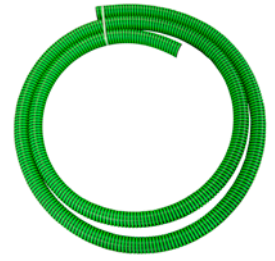

- Tube:** EPDM rubber
- Reinforcement:** Plastic helix
- Temperature:** -40°F to 140°F
- Colors:** Green, Yellow

Features:

- Specially compounded rubber wall, exposed plastic helix
- Excellent resistance to chemicals
- Lightweight and flexible
- Smooth bore, exposed helix - easy to drag

Part #		ID	OD	WP	Vacuum Rating	Min. Bend Radius	Weight	Std. Length
Green	Yellow	in	in	psi	in/HG	in	lbs/ft	ft
004-0169-0050I	004-0163-0050I	1	1.34	50	29	1.9	0.23	100
004-0209-0050I	004-0203-0050I	1 ¼	1.65	50	29	3.2	0.34	100
004-0249-0050I	004-0243-0050I	1 ½	1.85	50	29	3.5	0.41	100
004-0329-0050I	004-0323-0050I	2	2.43	50	29	5.5	0.67	100
004-0489-0045I	004-0483-0045I	3	3.52	45	29	7.5	1.10	100
004-0649-0040I	004-0643-0040I	4	4.6	38	29	11.5	1.84	100

Eagle Green/Clear PVC Suction & Discharge Hose

Used for agricultural liquid fertilizer, air seeder lines, drain lines, irrigation lines, rock dusting, rental and construction dewatering pumps, trash pumps, mining applications, and water suction standard duty applications.



- Tube:** PVC tube with rigid PVC helix
- Temperature:** -10°F to +140°F

Features

- Smooth both inner & outer surface
- Ellipse shaped helix: sustains strength without added thickness
- Lightweight, highly flexible - excellent vacuum rating
- Transparent construction allowing visual confirmation of material flow

Part #		ID	OD	Min. Bend Radius	WP	Vacuum Rating	Burst Pressure (psi)			Weight	Standard Length
Clear	Green						water temp				
		in	in	in	psi	in/Hg	50°F	96°F	122°F	lbs	ft
007-0160-0085I	007-0169-0085I	1	1.24	3	85	29	313	256	185	0.26	100
007-0200-0085I	007-0209-0085I	1 ¼	1.54	4	85	29	284	228	156	0.34	100
007-0240-0070I	007-0249-0070I	1 ½	1.82	5	70	29	270	213	142	0.44	100
007-0320-0065I	007-0329-0065I	2	2.28	8	65	29	242	199	128	0.55	100
007-0400-0050I	007-0409-0050I	2 ½	2.83	10	50	29	228	185	128	0.79	100
007-0480-0060I	007-0489-0060I	3	3.35	12	50	29	199	171	100	0.97	100
007-0640-0050I	007-0649-0050I	4	4.45	14	50	29	199	171	100	1.71	100
007-0960-0040I	007-0969-0040I	6	6.67	25	30	28	156	114	57	3.70	100/20
007-1200-0040I	007-1289-0040I	8	8.83	30	30	28	156	114	57	6.05	20

Eagle Honey Bee Hose

Designed for pumps, rental and construction dewatering, trash pumps, septic & wastewater handling, standard-duty water suction.



Application: Pumps, rental and construction dewatering, trash pumps, septic & wastewater handling, standard-duty water suction

Tube: Flexible polyethylene (LDPE) tube

Reinforcement: Polyethylene (LDPE) ribs and cuffed ends

Temperature: -40°F to 150°F (Actual service temperature range is application dependent.)

Lengths: 2": 3/10/20/25/30/40/50/60 ft.
3": 3/20/25/30/50/60 ft.

Features:

- **Superior Flexibility!** Corrugated tube and ribs provides high flexibility, perfect for maneuvering in tight areas such as portable toilets.
- **"Cold-Flex" Materials** Hose remains flexible in sub-zero temperatures.
- **Crush Resistant** Will spring back to original shape after being crushed, will not kink!
- **Easy Slide Helix** Exposed ribs protect hose tube from cover wear, and allow hose to slide easily over rough surfaces. Easy-to-handle.
- **Leak Proof Cuffs** Overmolded cuffs eliminate leaking and will not separate from the hose. Each cuff and unit is 100% factory tested.

Part #	ID	OD	WP	Vacuum Rating	Min Bend Radius	Weight
	in	in	psi @ 68°F	in. Hg @ 68°F	in	lbs/ft
004-0329-0100I	2	2.76	15	29	3.5	0.65
004-0489-0100I	3	4.06	7	29	6.5	1.2

NOTE: Service life may vary depending on operating conditions and type of material being conveyed.



Petroleum Hose Solutions

Eagle Oilflex Tank Truck Hose

Designed for suction and discharge applications in truck and tank car transfer of gasoline, oil and other petroleum-based products with up to 50% aromatic content.



- Tube:** Black conductive, oil resistant Nitrile (NBR)
- Reinforcement:** High tensile textile cord, double steel helix.
- Cover:** Red corrugated – abrasion, ozone and hydrocarbon resistant.
- Temperature:** -40°F to +180°F
- Branding:** EAGLE OILFLEX 150 PSI WP
- Couplings:** Contact JGB for proper fitting recommendation and coupling procedure.

Part #	ID	OD	WP*	Bend Radius	Weight
	in	in	psi	in	lbs/ft
009-0243-0150I	1 ½	1.97	150	3	0.74
009-0323-0150I	2	2.52	150	3	1.06
009-0483-0150I	3	3.54	150	4	1.85
009-0643-0150I	4	4.65	150	6	2.60
009-0963-0150I	6	6.77	150	18	6.00
009-1283-0150I	8	8.86	150	25	9.00

* Full Vacuum

Eagle Tank Truck® 150 Hose

Designed for use in tank truck, bulk petroleum stations, and in plant oil service.



- Tube:** Oil resistant, black conductive Nitrile (NBR)
- Reinforcement:** Synthetic textile and twin helix steel wire
- Cover:** Black, abrasion, ozone, weather, heat and oil resistant neoprene rubber
- Temperature:** -40°F to +180°F
- Branding:** EAGLE TANK TRUCK® SERVICE 150 PSI WP
- Couplings:** Contact JGB for proper fitting recommendation and coupling procedure.

Part #	ID	OD	WP*	Bend Radius	Weight
	in	in	psi	in	lbs/ft
009-0242-0125I	1 ½	1.93	150	4	0.92
009-0322-0125I	2	2.48	150	7	1.10
009-0402-0150I	2 ½	3.00	150	9	1.59
009-0482-0124I	3	3.50	150	9	1.86
009-0642-0150I	4	4.61	150	15	2.72
009-0962-0150I	6	6.69	150	26	5.21
009-1282-0150I	8	8.9	150	40	8.40

* Full Vacuum

Eagle Tank Truck® 300 PSI Hose

Designed for transport of mineral oil products and fuel mixtures with aromatic content up to 50%.



- Tube:** Oil resistant, black conductive Nitrile (NBR)
- Reinforcement:** High tensile textile cord, steel helix, crossing antistatic wires
- Cover:** Black corrugated - abrasion, ozone and hydrocarbon resistant neoprene
- Temperature:** -40°F to +180°F
- Branding:** EAGLE TANK TRUCK® SERVICE 300 PSI WP
- Couplings:** Contact JGB for proper fitting recommendation and coupling procedure.

Part #	ID	OD	WP*	Min Bend Radius	Weight
	in	in	psi	in	lb./ft.
009-0322-0300I	2	2.59	300	6	1.55
009-0482-0300I	3	3.74	300	9	2.46
009-0642-0300I	4	4.92	300	13	4.25
009-0962-0300I	6	7.08	300	25	7.74
009-1282-0300I	8	9.40	300	35	13.80

* Full Vacuum

Eagle O.S.&D. Hose

Designed for oil/water suction and delivery service. Full vacuum.



- Tube:** Oil and fuel resistant conductive nitrile (NBR), 50% Aromatics
- Reinforcement:** Multiple high tensile synthetic tire cords (polyester cords) with steel wire helix
- Cover:** Oil, weather and ozone resistant, cloth impression, black synthetic rubber
- Temperature:** -40°F to 194°F
- Packaging:** Custom Skids
- Branding:** EAGLE OIL SERVICE S&D® CARGO 250 MAX WP #Q## MEETS USCG 33CFR 154.500
- Couplings:** Built-in pipe flanges fixed x floating (ANSI B16.5)
- Lengths:** 10 ft. and 20 ft. standard length

Part #		ID	OD	Bend Radius	WP	Weight*	
10"	20'	in	in	in	psi	lbs	
						10'	20'
**	009-0483-0020	3	4-3/4	15	250	-	110
**	009-0643-0020	4	37377	19	250	100	176
009-0963-0010	009-0963-0020	6	37438	29	250	183	265
009-1283-0010	009-1283-0020	8	37500	38	250	214	368
009-1603-0010	009-1603-0020	10	37561	48	250	342	540
009-1923-0010	009-1923-0020	12	13-3/4	48	250	503	732
009-2242-0010	009-2240-0020	14	15-3/4	68	250	573	845
009-0256-0010	009-0256-0020	16	17-3/4	78	250	765	1130
009-2883-0010	009-2883-0020	18	20	106	250	946	1408

* Assembled weight

**Made to Order

Eagle Gravity Fuel Drop Hose

Designed to deliver gasoline, diesel fuel, kerosene and fuels with aromatic content to 40%.



Tube: NBR/PVC tube, smooth bore with embedded Safety Ohm ground wire in the hose wall

Reinforcement: Rigid clockwise PVC helix, one braid of high tensile polyester yarn reinforcement

Lengths: 100 ft.

Temperature: -10°F to +140°F

Couplings: Contact JGB for proper fitting recommendation and coupling procedure.

Features

- ** Up to 50% lighter than conventional rubber hose.
- Higher transfer pressures.
- Easy to drag with "Go-Glide" external clockwise PVC helix.
- Safety Ohm ground wire embedded into hose wall to help prevent the build-up of static electricity. Wire must be secured to ground to dissipate static electricity

Part #	ID	OD	Reinf. Spirals	Min Bend Radius	Max WP 68°F	Vacuum 68°F	Weight
	in	in		in	psi	ft.	lbs/ft
009-0324-0120I	2	2.68	1	5	70	29.9	1.13
009-0484-0120I	3	3.68	1	6	65	29.9	1.37
009-0644-0121I	4	4.80	1	8	65	29.9	2.16



Eagle PU Vapor Recovery Hose

Anti-static tank truck vapor recovery hose

- Tube:** Polyurethane (TPU)
- Reinforcement:** Rigid PVC helix and embedded grounding wire
- Cover:** Green Corrugated
- Temperature:** -40°F to +140°F
- Couplings:** Contact JGB for proper fitting recommendation and coupling procedure.

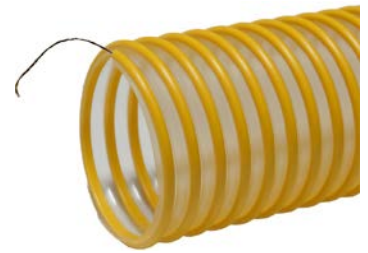

- Features**
- Biofuel Compatible - Revolutionary polyurethane compound! Specially designed to handle gasoline, ethanol (Meeting ASTM D5798, D4806 or D6751 criteria.), diesel and biodiesel (Meeting ASTM D5798, D4806 or D6751 criteria.) vapors... and still keeps all the other great features and benefits!
 - Non-permeable polyurethane construction -won't swell or become stiff like conventional TPR/rubber hoses. Long life reduces operating costs.
 - Lightweight - much lighter than conventional TPR/rubber hoses.
 - Superior flexibility - especially in sub-zero weather!
 - See-through" construction - for visual confirmation if fuel backs up into the vapor recovery system.
 - Grounding Wire - Durable multi-strand copper wire dissipates static electricity. Physically extract wire from the rigid helix and bond to the metal coupling (or by other means) to ground.
 - Easy Slide Helix - Rigid counter clockwise helix design protects hose tube from cover wear; allows hose to slide easily over rough surfaces.

Part #	ID	OD	Min Bend Radius	WP	Standard Length	Weight
	in	in	in	psi	ft.	lbs/ft
009-0320-0001I	2	2.46	3.0	17	100	0.51
009-0480-0001I	3	3.51	3.5	11	100	0.78
009-0640-0001I	4	4.56	4.5	9	100	1.10

Sleeve:

Part #	ID	Weight
	in	lbs/ft
031-03225-007I	2	0.51
031-04845-007I	3	0.78
031-06445-005I	4	1.10



Material Handling Hose

Eagle Uremat® Hose

A polyurethane lined hose used for handling abrasives such as pellets, rocks, sands, chips, grains transfer. Also used for industrial vacuuming, and as a shot line, bark blow line, or for lawn/mulch/straw collection.

Tube: Highly flexible, static dissipative black HMC PVC compound with polyurethane lining

Cover: Black PVC convoluted cover

Couplings: Contact JGB for proper fitting recommendation and coupling procedure.



Part #	ID	OD	WP	Standard Length	Min Bend Radius	Weight
	in	in	psi	ft	in	lbs/ft
014-0241-0100I	1 ½	1.85	50	100	2	0.42
014-0321-0100I	2	2.40	40	100	3	0.59
014-0401-0100I	2 ½	3.09	40	100	3	0.82
014-0481-0100I	3	3.64	40	100	4	1.18
014-0641-0100I	4	4.76	35	100	6	1.94
014-0801-0100I	5	5.75	35	100	10	2.45
014-0961-0100I	6	6.80	30	100	12	3.50
014-1281-0100I	8	9.16	30	60	18	5.90

Eagle Uremat® HD Hose

A polyurethane lined hose used for handling abrasives such as pellets, rocks, sands, chips, grains transfer. Also used for industrial vacuuming, and as a shot line, bark blow line, or for lawn/mulch/straw collection.

Tube: Highly flexible, static dissipative HMC PVC compound with polyurethane lining

Cover: PVC convoluted cover

Couplings: Contact JGB for proper fitting recommendation and coupling procedure.



Part #	ID	OD	WP	Standard Length	Min Bend Radius	Weight
	in	in	psi	ft	in	lbs/ft
014-0241-0100IHD	1 ½	1.88	50	100	3	0.46
014-0321-0100IHD	2	2.44	40	100	4	0.65
014-0401-0100IHD	2 ½	3.12	40	100	5	0.89
014-0481-0100IHD	3	3.70	40	100	6	1.23
014-0641-0100IHD	4	4.80	35	100	10	2.02
014-0801-0100IHD	5	5.81	35	100	14	2.50
014-0961-0100IHD	6	6.87	30	100	18	3.84
014-1281-0100IHD	8	9.18	30	60	22	6.52

Novaflex Sludge Slayer Hose

Heavy duty material handling hose designed for portable and central industrial vacuum equipment as well as truck mount applications. The 5/16" abrasion resistant tube is designed to resist cutting, tearing and wear from abrasive media. The heavy helix wire is designed to resist kinking and crushing as well as handle full vacuum. (Ground using helix wire to make static conductive.)



Tube: 5/16" White gum

Reinforcement: Plies of fabric with helix wire

Cover: Green Corrugated

Temperature: -40°F to +160°F

Length: 50 ft.

Couplings: Contact JGB for proper fitting recommendation and coupling procedure.

Part #	ID	Nom OD	WP	Min Bend Radius	Vacuum Rating	Weight
	in	in	psi	in	in/Hg	lbs/ft
*	1 ½	1.82	45.0	2.0	29.8	0.37
*	2	2.35	40.0	2.5	29.8	0.50
014-0402-5010	2 ½	2.95	35.0	2.5	29.8	0.73
014-0482-5010	3	3.50	35.0	3.0	29.8	1.10
014-0649-0001	4	4.63	30.0	4.5	29.8	1.77
*	5	5.76	30.0	5.0	28	2.47
014-0962-5010	6	6.73	30.0	9.2	28	3.08
014-1282-5010	8	9.04	30.0	15.0	27	5.65

*Call for Availability

Boarvac Suction Hose

Designed for heavy duty abrasive resistant suction hose for vacuum trucks or handling abrasives such as crushed rock, sand, pea gravel, cement, dry fertilizer, iron ore, and grains.

Tube: SBR rubber blended with static carbon black, smooth bore, corrugated O.D.

Reinforcement: Rigid PVC helix

Temperature: -40°F to +140°F

Branding: Boarvac

Couplings: Contact JGB for proper fitting recommendation and coupling procedure.



Part #	ID	Nom OD	WP	Min Bend Radius	Vacuum Rating	Weight
	in	in	psi	in	in/Hg	lbs/ft
014-0242-0045I	1 ½	1.82	45.0	2.0	29.8	0.37
014-0322-0040I	2	2.35	40.0	2.5	29.8	0.50
014-0402-0035I	2 ½	2.95	35.0	2.5	29.8	0.73
014-0480-0035I	3	3.50	35.0	3.0	29.8	1.10
014-0642-0030I	4	4.63	30.0	4.5	29.8	1.77
014-0800-0030I	5	5.76	30.0	5.0	28	2.47
014-0962-0030I	6	6.73	30.0	9.2	28	3.08
014-1282-0030I	8	9.04	30.0	15.0	27	5.65

Eagle Bulk® Material HD Hose

Used for pneumatic transport of abrasive materials such as cement and sand, and other dry abrasive bulk materials. Also used for the anti-static transfer of materials that create static buildup on the liner (anti-static compound in hose liner protects from static electricity).



Tube: 1/4 inch abrasion resistant layer of synthetic and natural elastomer blend, smooth
1/8 inch abrasion resistant layer of synthetic and natural elastomer blend, smooth

Reinforcement: High tensile textile cord

Cover: Blend of synthetic and natural elastomers, black, smooth with cloth impression, antistatic, abrasion, weather, and ozone resistant. Black SBR

Temperature: -30°F to +185°F

Branding: 4" EAGLE BULK® MATERIAL 75 PSI

Lengths: 100 ft.

Part No.	ID	OD	Plies	Tube Construction	Max WP	Weight
	in	in	psi	lbs/ft	psi	lbs/ft
014-0642-0074I	4	4.49	2	1/8"	75	1.67
014-0642-0075I	4	4.72	2	1/4"	75	2.14

Eagle Hot Air® Blower Hose

Used for conveying hot air from a blower or compressor to tanks on dry bulk material carriers.

Tube: Black EPDM

Reinforcement: Multiple plies of high tensile textile with dual steel wire helix

Cover: Black EPDM

Temperature: -40°F to 400°F

Branding: EAGLE HOT AIR® BLOWER 150 PSI / 400 DEG. F. MAX

Lengths: 100 ft.



Part No.	ID	OD	Bend Radius	WP	Weight
	in	in	in	psi	lbs/ft
014-0482-0150I *	3	3.58	10	150	1.89
014-0642-0150I	4	4.72	13	150	2.41

* Full Vacuum

Discharge Hose

Eagle Nitrile® 150PSI Hose

Designed as a dependable & durable, yet lightweight and flexible solution for high volume, high pressure water transfer applications. It allows for quick layout and retrieval and is typically used in dewatering operations, irrigation, sewage, and general pumping duties.

This hose is constructed using an "Extruded Thru the Weave" (ETW) manufacturing process.



- Tube:** Blend of synthetic elastomers, smooth, oil resistant, black
- Reinforcement:** Single high tensile textile braid
- Cover:** Yellow, blend of synthetic elastomers compound, ribbed finish
- Temperature:** -4°F to 176°F
- Branding:** EAGLE NITRILE 150#
- Couplings:** Contact JGB for proper fitting recommendation and coupling procedure.
- Colors:** Black, orange, yellow
- Safety Factor:** 4:1
- Lengths:** 100 ft. standard lengths (Long length available upon request)

Part #	Nom. ID	OD	WP	End Pull	Bend Radius	Weight
	in	in	psi	lbs	in	lbs/ft
008-0242-1150I	1 ½	.08	150	1980	2.30	0.21
008-0322-1150I	2	.08	150	2860	3.60	0.30
N/A	2 ½	.08	150	3080	4.25	0.42
008-0402-1150I	3	.10	150	3960	4.75	0.46
008-0642-1150I	4	.10	150	5280	5.60	0.64
N/A	5	.12	150	9240	6.90	0.97
008-0962-1150I	6	.12	150	11000	7.40	1.11
008-1282-1150I	8	.12	150	14000	9.85	1.51
008-1600-0175	10	.14	150	17000	10.50	2.50
008-1922-1150I	12	.20	150	31500	11.25	3.92

Eagle Flo Blue PVC Discharge Hose

Used for light duty, general purpose agricultural, irrigation, and construction applications.

- Tube:** Blue PVC
- Reinforcement:** Polyester yarn
- Cover:** Blue PVC
- Temperature:** -4°F up to 150°F
- Branding:** EAGLE FLO® WATER DISCHARGE
- Couplings:** Standard short shank aluminum, malleable or brass couplings
- Lengths:** Cut and coupled to length.



Part #	ID	Thickness	WP	Weight
	in	in	psi	lbs/ft
008-0166-0070I	1	0.051	70	0.10
008-0246-0080I	1 ½	0.055	80	0.17
008-0326-0080I	2	0.060	80	0.23
008-0486-0080I	3	0.063	70	0.40
008-0646-0080I	4	0.063	70	0.52
008-0966-0080I	6	0.071	50	0.85

Standard Size (in)	M x F	C x E
	1 ½ x 50	A008-0246-1650
2 x 50	A008-0326-1650	A008-0326-3550
3 x 50	A008-0486-1650	A008-0486-3550
4 x 50	A008-0646-1650	A008-0646-3550
6 x 50	A008-0966-1650	A008-0966-3550

Eagle Red PVC HD Discharge Hose

Designed for agricultural, quarry, irrigation, mining, construction and industrial applications.

- Tube:** Premium Red PVC
- Reinforcement:** Two spiral plies and longitudinal silk cords
- Cover:** Premium Red PVC
- Temperature:** -10°F up to 150°F
- Branding:** EAGLE WATER DISCHARGE HD
- Couplings:** Standard short shank aluminum, malleable or brass couplings, Steel Bauer
- Lengths:** Cut and coupled to length.



Bulk

Part #	ID	Thickness	WP	Weight
	in	in	psi	lb./ft.
008-0241-0150I	1 ½	0.075	150	0.20
008-0321-0150I	2	0.080	150	0.28
008-0481-0150I	3	0.095	150	0.54
008-0641-0125I	4	0.100	125	0.67
008-0961-0115I	6	0.105	115	1.25
008-1281-0070I	8	0.110	70	1.48
008-1926-0040I	12	0.112	40	2.43

Assemblies

Standard Size (in)	M x F	C x E
1 ½x50	A008-0241-1650	A008-0241-3550
2x50	A008-0321-1650	A008-0321-3550
3x50	A008-0481-1650	A008-0481-3550
4x50	A008-0641-1650	A008-0641-3550
6x50	A008-0961-1650	A008-0961-3550

Eagle Mill® Discharge Hose

Designed as a medium pressure PVC discharge hose, for light-duty water discharge

- Tube:** SBR
- Cover:** 100% Polyester
- Temperature:** -25°F up to 185°F
- Branding:** EAGLE MILL® 250 SJ
- Couplings:** Stock hose assemblies with banded C/E
Stock hose assemblies with banded water shanks
- Lengths:** 50 ft. and 100 ft. stock lengths
- Colors:** White



Single Jacket

Part#	ID	WP	Test Pressure	Weight
	in	psi	psi	lbs
005-0245-0250I	1 ½	150	250	0.230
005-0325-0250I	2	150	250	0.280
005-0400-0250I	2 ½	150	250	0.390
005-0485-0250I	3	150	250	0.500
005-0645-0250I	4	150	250	0.660

Double Jacket

Part#	ID	WP	Test Pressure	Weight
	in	psi	psi	lbs
005-0245-0600I	1 ½	250	600	0.260
005-0325-0600I	2	250	600	0.330
005-0400-0600I	2 ½	250	600	0.450
005-0485-0600I	3	250	600	0.607
005-0645-0600I	4	250	600	0.849

Sandblast Hose & Assemblies

Thunderblast® Sandblast Hose 2/4 Ply

Specially designed hose for use in all abrasive blast applications, suitable for all commonly used blasting media.



Tube: Black Static Conductive Natural Rubber
4 ply: 1/2" - 3/4" ID have 1/4" tube thickness, 1" - 2" ID have 5/16" tube thickness
2 ply: All sizes, 1/4" tube thickness

Reinforcement: High Tensile Textile Plies

Cover: Black Abrasion Resistant SBR

Temperature: -40°F to +185°F (-40°C to +85°C)

Branding: THUNDERBLAST® 4 PLY 175 PSI WP

Lengths: 50 ft & 100 ft. standard (Contact JGB for 200 ft. bulk length availability)

Standards: * EN ISO 3861
 * Abrasion loss Value: According to DIN 53516 ≤ 60 mm³

- Features**
- With black high abrasion, static conductive natural rubber tube
 - Black abrasion resistant cover with green layline
 - 1-1/2" & 2" sizes rated to 150 PSI

Part #	ID	OD	Plies	WP	Weight
	in	in		psi	
011-2082-0150/011-4082-0150	1/2	1-1/16/1-3/16	2/4	175	.36 / .38
011-2120-0150 / 011-2122-0150	3/4	1-5/16/1-1/2	2/4	175	.48/.69
011-2162-0151/011-4162-0150	1	1-1/2/1-7/8	2/4	175	.78/1.03
011-2202-0175/011-4202-0150	1 1/4	1-7/8 / 2-5/32	2/4	175	.83/1.23
011-4242-0150	1 1/2	2-3/8	4	150	1.33
011-0322-0150I	2	2-7/8	4	150	1.66

Size	Quick Coupling Size	External Nozzle Holders Size
in	in	in
1/2 x 1-1/16 2 Ply	1/2 Aluminum	1/2 Aluminum
3/4 x 1-1/2 4 Ply	3/4 Aluminum	3/4 Aluminum
1 x 1-7/8 4 Ply	1 Aluminum	1 Aluminum
1-1/4 x 2-5/32 4 Ply	1-1/4 Aluminum	1-1/4 Aluminum
1-1/2 x 2-3/8 4 Ply	1-1/2 Aluminum	1-1/2 Aluminum



Eagle 700 Metal Hose Assembly

Eagle 700 series corrugated hose is a high quality general purpose industrial hose.

Construction: SS 316L corrugated flexible hose with SS 304 double wire braiding

Couplings: TIG welded with 150# SS 316 swivel flanges at both ends with SS 316 Sch. 40 stub end

Safety: 4:1



Quality Certifications & Testing:

- Hydrostatic & pneumatically tested
- ISO 14001:2004
- Ped Certified

Part #	Part #	ID	Nom ID	Nom OD	Static Bend Radius	Dynamic Bend Radius	Max WP	Weight	
								lbs	
10 ft. length	20 ft length	in	in	in	in	in	psi	10'	20'
106-0160-0710	106-0160-0720	1	1	1.63	3	9	1137	31	53
106-0320-0710	106-0320-0720	2	1.98	2.77	5	15	867	44	76
106-0480-0710	106-0480-0720	3	3.15	3.99	9	22	526	61	103
106-0640-0710	106-0640-0720	4	4.36	5.06	10	24	455	98	163
106-0960-0710	106-0960-0720	6	5.93	7.12	18	31	312	163	277
106-1280-0710	106-1280-0720	8	7.76	9.29	19	37	270	251	421
106-1600-0710	106-1600-0720	10	9.86	11.45	25	51	174	267	423
106-1920-0710	106-1920-0720	12	11.82	13.5	31	61	151	353	553



Eagle Composite® Hose

Recommended for loading and unloading barges, ocean tanker & bunkering services, and is recommended for other doc side operations. The spiral wound high tensile galvanized inner and outer wires provide the strength and flexibility to maintain hose integrity.



Application: Suction and Discharge of Gasoline, Diesel fuel, Paraffin, Kerosene, Lubricating Oils, 100% aromatics, black oils and heavy lubricants and solvents.

Carcass: Multiple layers of polypropylene fabric, film and polyester barrier layers

Reinforcement: High tensile strength galvanized inner and outer wire

Cover: Abrasion resistant PVC impregnated fabric

Temperature: -22°F to +176°F (-30°C to +80°C)

Flange: Fix x floating per ANSI B 16.5 CARBON STEEL 150LBS SPECIFICATION
(*Complies with USCG 33CFR 154.500)

Vic: Standard cut groove carbon steel vic

Branding: EAGLE COMPOSITE® OIL SERVICE S&D CARGO 200PSI MAX WP #Q## USCG 33CFR 154.500

Part #	ID	Max WP	Burst	Bend Radius	Weight	Max. Length
	in	psi	psi	in	lb/ft	ft
006-0642-0010I/0020I	4	200	850	16	3.5	65
006-0962-0010I/0020I	6	200	850	23	7.7	65
006-1280-0010I/0020I	8	200	850	32	12.0	65
006-1600-0010I/0020I	10	200	850	40	16.9	40
006-1920-0010I/0020I	12	200	850	47	19.8	40

Approximate weight of Fix x Floating Flange

Size	Length	Weight	Length	Weight
in	ft	lbs	ft	lbs
4	10	70.55	20	99.20
6	10	160.94	20	233.69
8	10	264.56	20	381.40
10	10	363.76	20	507.06
12	10	551.25	20	760.01

Approximate weight of Vic x Vic

Size	Length	Weight	Length	Weight
in	ft	lbs	ft	lbs
4	10	52.91	20	85.98
6	10	136.69	20	209.44
8	10	227.08	20	343.92
10	10	319.67	20	462.97
12	10	396.43	20	696.16

UHMWPE Chemical Hose & Assemblies

Eaglechem® UHMWPE Chemical Suction & Discharge Hose

Designed for almost every common industrial chemical used in chemical transfer applications today.
Not for steam service, can be open-end steam cleaned.



Tube: Ultra-High Molecular Weight polyethylene (UHMW-PE), clear, smooth, food quality, resistant to a wide range of chemicals

Reinforcement: High tensile textile cord, dual galvanized steel helix

Cover: EPDM - Green, smooth with cloth impression, resistant to weather, ozone and abrasion (Available in red, blue, yellow black and grey, white and orange - with 400 ft. order)

Temperature: -40°F to 212°F, 250°F (Intermittent)

Branding: EAGLECHEM® UHMWPE CHEMICAL TRANSFER 240 PSI MAX WP

Lengths: 100 ft.

Part #	ID	OD	WP	Vacuum	MBR	Weight
	in	in	psi	in HG	in	lbs/ft
006-0129-0240I	3/4	1.19	240	29	3.5	0.58
006-0166-0240I	1	1.47	240	29	4	0.63
006-0246-0240I	1 ½	2.08	240	29	4	1.06
006-0326-0240I	2	2.58	240	29	6	1.33
006-0406-0240I	2 ½	3.03	240	29	10	1.78
006-0480-0240I	3	3.61	240	29	16	2.12
006-0646-0240I	4	4.61	240	29	24	2.83
006-0969-0240I	6	6.89	240	26	36	6.89

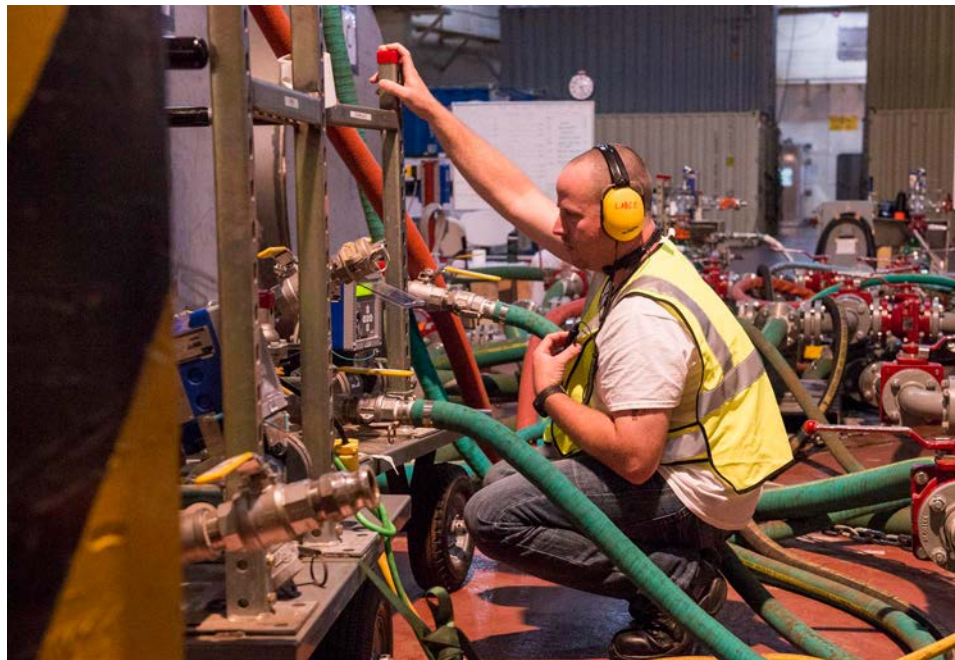

Red Air Hose Assemblies

Eagle Air® Jackhammer Hose

Designed for connection to pneumatic tools.

- Tube:** SBR NR
- Reinforcement:** Spiral Polyester Yarn
- Cover:** EPDM
- Temperature:** -22°F to 176°F
- Branding:** 3/4" Eagle Air® JH 300PSI MAX WP #Q##
- Oil Resistance:** Limited
- Packaging:** 50 ft. length each with PVC film



- Features**
- Eagle Air™ comes in red or yellow
 - Pre-assembled in 3/4" x 50" size
 - Coupled with universal couplings

Part #	ID	OD	WP	Burst Pressure	Standard Length	Reinforcement
	in	mm	psi	psi	ft	Spiral
001-0121-0050I	3/4	29.5	300	900	50	2

Eagle Shop Air Hose

Air compressor hose

- Tube:** SBR + NR
- Reinforcement:** 2 Spiral Polyester Yarn
- Cover:** EPDM
- Temperature:** -22°F to 176°F
- Branding:** 3/8" EAGLE AIR® 300 PSI MAX WP #Q##
- Packaging:** 50 ft. length each with shrink film
- Couplings:** 1/4 NPT x 18 fitting at both ends
- Oil Resistance:** Limited



Part #	ID	OD	WP	Burst Pressure	Standard Length
	in	in	psi	psi	ft
001-0061-0050I	3/8	16.5	300	900	50

Contractor's Water Hose and Assemblies

Eagle Contractor's Water Hose

Designed as a traditional rubber water hose coupled with standard MxF Garden Hose Thread (GHT) solid brass fittings. This hose features a black PVC bend restrictor at female end to prevent kink and wear at hookup.

- Tube:** SBR+NR
- Reinforcement:** Spiral polyester yarns
- Cover:** EPDM
- Temperature:** -22°F up to 176°F
- Branding:** EAGLE CWH CONTRACTORS WATER HOSE 200 PSI MAX WP #Q##
- Couplings:** Male x female octagonal nut spun brass garden hose coupling with brass ferrules
- Lengths:** 50ft/coil, (Custom lengths available)
- Colors:** Black



Part #	ID	Length	WP	Weight
	in	ft	psi	lbs/ft
001-0102-0150I	5/8	50	200	15
001-0122-0150I	3/4	50	200	20

* Custom lengths available



Yellow Air Hose (BULL HOSE)

Eagle Air® Wire Reinforced Hose

Heavy duty air hose for use in mines, construction and industrial applications where maximum service is required.



Tube: Blend of SBR and NBR, black, smooth, suitable for water and air, resistant to oil mist

Reinforcement: Brass coated steel wire

Cover: Blend of EPDM and SBR, yellow, smooth with cloth impression, weather, ozone and abrasion resistant

Temperature: -22°F to 200°F

Branding: EAGLE AIR® 600 PSI MAX WP

Lengths: 100 ft.

Features:

- High safety against bursting, robust, long lasting

Part #	ID	OD	WP	Burst Pressure	Bend Radius	Weight
	in	in	psi	psi	in	lbs/ft
003-0323-0600I	2	2.6	600	2400	8	1.69
003-0483-0600I	3	3.7	600	2400	15	3.02
003-0640-0500I	4	4.8	600	2400	20	4.54
003-0963-0600I	6	7.12	600	2400	37	8.03

Eagle Air® 300 PSI Textile Hose

Robust air hose for heavy duty applications in heavy industry, construction and mining.



Type: Mandrel built

Tube: Blend of synthetic elastomer compound, black, smooth, suitable for water and air, resistant to oil mist

Reinforcement: High tensile textile cord

Cover: Synthetic elastomer compound, yellow, smooth with cloth impression, weather, ozone and abrasion resistant

Temperature: -22°F to 185°F

Branding: EAGLE AIR® 300 PSI MAX WP

Max Lengths: 200 ft.

Standard Notice: EN ISO 2398

Lengths: 100 ft.

Features:

- Robust yet flexible
- Long lasting, yellow color

Part #	ID	OD	Max WP	Burst Pressure	Weight
	in	in	psi	psi	lbs/ft
001-0243-0300I	1 ½	52	300	900	1.01
001-0323-0300I	2	65	300	900	1.42
001-0403-0300I	2 ½	82	300	900	1.94
001-0483-0300I	3	92	300	900	2.35
001-0640-0300I	4	124	300	900	3.56

Sewer Cleaning Hose Assemblies

Dyna Flex Sewer Cleaning SWRBLUE (Blue) 3000 PSI - Hydraulic Hose

For use on high pressure sewer cleaning equipment.



- Tube:** Orange seamless polyolefin tube
- Reinforcement:** Two braids of high tensile synthetic fiber
- Cover:** Bonded blue high abrasion mold and fungus resistant polyether-urethane featuring an anti-stick additive for a snag resistant slick surface.
- Temperature:** -40 degrees F. to +122 degrees F.

Part #	Nom. I.D.		Nom. O.D.		Max. Oper. Pressure		Min. Burst Pressure		Min. Bend Radius (In.)	Wgt. Per 100 Ft. (Lbs.)
	In.	mm.	In.	mm.	PSI	BAR	PSI	BAR		
SWRBLUE-12	3/4	19.05	1.18	29.85	3000	207	7500	517	5.0	29.0
SWRBLUE-16	1	25.40	1.46	37.08	3000	207	7500	517	7.0	42.0

Piranha Armor Belt Sewer Cleaning Hoses 4,000 PSI Series LAGR

For use on high pressure sewer cleaning applications and harsh environments requiring additional abrasion resistance.

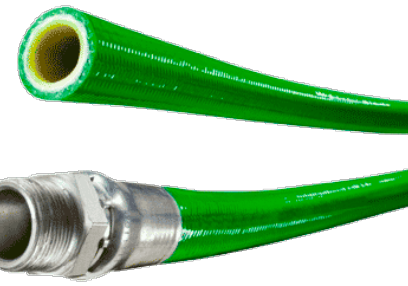

- Tube:** Polyolefin Tube - Provides maximum resistance to hydrolysis
- Reinforcement:** High tensile double synthetic fiber braids
Polymer Belting - Protects reinforcement.
- Cover:** Polyether-Urethane Cover - Provides fungus resistance
- Temperature:** -40°F (-40°C) to +150°F (+66°C)
- Lengths:** Standard Lengths - 400, 500, and 600 foot rolls. (Custom lengths available)
- Color:** Green

Features & Advantages:

- Patented Armor Belt Construction - Increases hose abrasion and cut resistance for longer service life.
- Greatly increased crush resistance.
- Provides rugged and reliable service.
- Polyolefin Tube - Provides maximum resistance to hydrolysis.
- High Tensile Synthetic Fiber Reinforcement - Contributes to low volumetric expansion and eliminates loss of strength from moisture absorption.
- Polyether-Urethane Cover - Provides fungus resistance.
- Unique Construction - All hose components are chemically bonded to maximize hose service life.
- Optional Slither® Ultra Slick Cover - Design is also available; check with factory for details.
- Factory Assemblies - All Piranha® factory-assembled hoses are 100% pressure tested.
- Reel Installation - Ideal for truck and trailer mounted reels.
- The Toughest Hose in the Market
- Lightweight
- Extremely durable against normal wear and tear
- Highly abrasive resistant
- Excellent cut resistance
- Greatly increased crush resistance
- Designed to be tougher and last longer

Series Number	Nom. I.D.		Nom. O.D.		Max Operating Pressure		Min Burst Pressure		Min Bend Radius		Weight lbs/ft
	Inches	MM	Inches	MM	PSI	BAR	PSI	BAR	Inches	MM	
LAGR-08	1/2	12.7	1.00	25.4	4,000	275.8	10,000	689.5	3.00	76.2	0.19

Piranha Slither High Pressure Sewer Cleaning Hose 3,000 PSI Series SLBU, SLHPBU

For use on high pressure sewer cleaning applications for commercial, industrial and residential service..

- Tube:** PYellow Polyolefin
- Reinforcement:** High tensile double synthetic fiber braids
- Cover:** Abrasion resistant polyether-urethane with low coefficient of friction.
- Temperature:** -40°F (-40°C) to +150°F (+66°C)
- Lengths:** Standard Lengths - 400, 500, and 600 foot rolls. (Custom lengths available)
- Color:** Blue

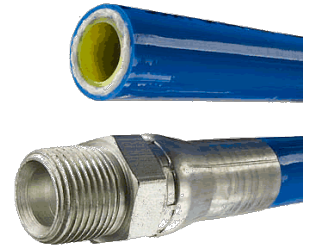

Features & Advantages

- **Materials** - Constructed to provide rugged and reliable service under the most severe and demanding conditions.
- **Yellow Color Tube** - Assures the user that they are using a WASTECH designated Piranha® Hose Product.
- **Polyolefin** - Provides maximum resistance to hydrolysis.
- **High Tensile Double Synthetic Fiber Braids** - Contributes to low volumetric expansion and eliminates loss of strength from moisture absorption.
- **Abrasion Resistant Polyether-Urethane** - Polyurethane cover provides exceptional cut, abrasion and fungus resistance.
- **Slither® Cover** - Cover is ultra-slippery; allows hose to maneuver around and through difficult sewer bends.
- **Pressure Testing** - All Piranha® factory-assembled hoses are 100% pressure tested.
- **Reel Installation** - Ideal for truck and trailer mounts.

Series Number	Nom ID	Nom OD	Max Operating Pressure	Min Burst Pressure	Min Bend Radius	Weight
SLBU-08	1/2 in 12.8 mm	0.83 in 21.2 mm	3000 psi 206.8 bar	7500 psi 517.1 bar	4.00 in 101.6 mm	0.16 lbs/ft
SLHPBU-12	3/4 in 19.1 mm	1.18 in 30.0 mm	3000 psi 206.8 bar	7500 psi 517.1 bar	5.00 in 127.0 mm	0.29 lbs/ft
SLHPBU-16	1 in 25.4 mm	1.48 in 37.6 mm	3000 psi 206.8 bar	7500 psi 517.1 bar	8.00 in 203.2 mm	0.41 lbs/ft

Steam Hose & Assemblies

Eagle EPDM 270 PSI Steam Hose (Red)

Used for the transfer of saturated and superheated steam up to 270 PSI and max 450°F in shipyards, chemical plants and industrial applications.



*** Proper draining of steam hose after each use will increase service life.**

*** Not recommended for washdown applications where detergent or oils are present.**

WARNING:

Handling steam is very hazardous. If it is not properly controlled it can cause property damage, injury or even death. Selection for the proper application, usage, and maintenance will not only increase hose life but will insure safe operation for the user.

Tube: Black heat-resistant extruded EPDM. *Not for steam cleaner use.*

Reinforcement: High tensile steel wire braids.

Cover: Red heat-resistant EPDM rubber. Wrapped cover fabric impression. Pin-pricked cover to allow venting.

Temperature: -40°F to +410°F (Intermittent 450°F)

Branding: EAGLE EPDM STEAM 270 PSI WP

Couplings: Contact JGB for proper fitting recommendation and coupling procedure.

Lengths: 50 or 100 feet

Part #	ID	OD	Min Bend Radius	WP	Weight
	in	in	in 68°F	psi	lbs
*	1/2	0.98	5	270	.29
*	3/4	1.26	7 ½	270	.53
010-0161-0270I	1	1.50	10	270	.61
*	1 ¼	1.81	12 ½	270	.86
*	1 ½	2.05	15	270	.93
010-0321-0270I	2	2.64	20	270	1.38

* Non-stock

Quick Couplers (QDs)

FPT Socket



Thread Size	Socket Size	Part #
1/4"	1/4"	188-C20
1/4"	3/8"	188-C2622
3/8"	1/4"	188-C2023
3/8"	3/8"	188-C26
3/8"	1/2"	188-C10
1/2"	3/8"	188-C2624
1/2"	1/2"	188-C10

MPT Socket



Thread Size	Socket Size	Part #
1/4"	1/4"	188-C20
1/4"	3/8"	188-C2622
3/8"	1/4"	188-C2023
3/8"	3/8"	188-C26
3/8"	1/2"	188-C10
1/2"	3/8"	188-C2624
1/2"	1/2"	188-C10

Hose Barb Socket



Thread Size	Socket Size	Part #
1/4"	1/4"	188-C2042
1/4"	3/8"	188-C642
3/8"	1/4"	188-C2044
3/8"	3/8"	188-C2644
3/8"	1/2"	188-C1044
1/2"	3/8"	188-C2645
1/2"	1/2"	188-C1045

FPT Plug



Thread Size	Socket Size	Part #
1/4"	1/4"	188-C20
1/4"	3/8"	188-C2622
3/8"	1/4"	188-C2023
3/8"	3/8"	188-C26
3/8"	1/2"	188-C1823
1/2"	3/8"	188-C2624
1/2"	1/2"	188-C18

MPT Plug



Thread Size	Socket Size	Part #
1/4"	1/4"	188-CP21
1/4"	3/8"	188-CP2502
3/8"	1/4"	188-CP-2103
3/8"	3/8"	188-CP25
3/8"	1/2"	188-CP1703
1/2"	3/8"	188-CP2504
1/2"	1/2"	188-CP17

Hose Barb Plug



Thread Size	Socket Size	Part #
1/4"	1/4"	188-CP2142
1/4"	3/8"	188-CP2542
3/8"	1/4"	188-CP-2144
3/8"	3/8"	188-CP2544
3/8"	1/2"	188-CP1744
1/2"	3/8"	188-CP2545
1/2"	1/2"	188-CP1745

Ground Joint Fittings (Boss)



Complete Female

Standard Size	Part #
1 1/2"	028-0241-1314
2"	028-0321-1314
3"	028-0481-1314



Female Stem

Standard Size	Part #
1 1/2"	028-0240-1021
2"	028-0320-1021
3"	028-0481-1318



Male Stem

Standard Size	Part #
1 1/2"	028-0241-1334
2"	028-0321-1334
3"	028-0481-1334



Male Spud

Standard Size	Part #
1 1/2"	028-0241-1316
2"	028-0321-1316
3"	028-0481-1316



Double Spud

Standard Size	Part #
1 1/2"	028-0241-1318
2"	028-0321-1318
3"	028-GDB38



Female Spud

Standard Size	Part #
1 1/2"	028-0241-1317
2"	028-0321-1317
3"	028-0481-1317



Wing Nut

Standard Size	Part #
1 1/2"	028-0240-1320
2"	028-0321-1320
3"	028-0481-1320

Male Stem also available in:

- Steel bar stock

All other ground joints also available in:

- Iron
- 316 stainless steel
- Brass

***Additional sizes also available, please contact JGB Enterprises with your requirements**

Universal Couplings (For Air & Water Service Only)

Universal Couplings

Barb

Size	Iron Model #	Brass Model #	316 Stainless Steel Model #
3/8"	028-0060-1019	028-ABH	028-RAMH
1/2"	028-0080-1019	028-0080-3019	028-0080-1019C
3/4"	028-0120-1019	028-0120-1018	028-0122-1330
1"	028-0161-1019	028-0160-1020	028-0160-1019C



Male

Size	Iron Model #	Brass Model #	316 Stainless Steel Model #
3/8"	028-0061-1332	028-ABB	028-RAMB
1/2"	028-0081-1332	028-0081-3332	028-0081-1337
3/4"	028-0121-1332	028-AB7	028-0121-1331
1"	028-0161-1332	028-0161-1332B	028-0162-1333



Female

Size	Iron Model #	Brass Model #	316 Stainless Steel Model #
3/8"	028-0061-1333	028-0061-3333	028-0061-1336
1/2"	028-0081-1333	028-0081-3333	028-0081-1336
3/4"	028-0121-1333	028-0121-3333	028-0121-1337
1"	028-0161-1333	028-0161-3333	028-0162-1332

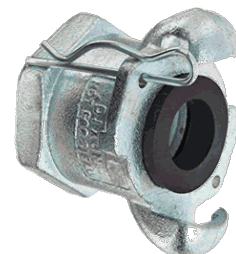

Triple Connection

Iron Model #	Brass Model #
028-0000-1019	028-0001-1019



Blank End

Iron Model #	Brass Model #	316 Stainless Steel Model #
102-AM0	1002-AB0	028-0122-1350



Vacuum Hose Couplings

Ringlock Fittings

STEEL RINGLOCK CLAMPS

Diameter in	Weight (lbs)
4	1.85
6	2.2
8	2.7



STEEL RINGLOCK MALE

Diameter in	Weight (lbs)
4	2.0
6	3.3
8	6.0



ALUM RINGLOCK FEMALE COUPLER

Diameter in	Weight (lbs)
6	1.3
8	2.15
10	.56



STEEL RINGLOCK LINE TEE

Diameter in	Weight (lbs)
4	6.35
6	14.35
8	30.5



ALUM RINGLOCK LINE TEE

Diameter in	Weight (lbs)
6	7.5
8	14.0
10	20.425



ALUM RINGLOCK END TEE

Diameter in	Weight (lbs)
4	6.9
6	8.188
8	-



ALUM RINGLOCK REDUCER

Diameter in	Weight (lbs)
6	-
8	4.9
10	7.4



ALUM RINGLOCK 45° ELBOW

Diameter in	Weight (lbs)
6	-
8	6.635
10	-



ALUM RINGLOCK 90° ELBOW

Diameter in	Weight (lbs)
6	2.3
8	4
10	6.5



Ringlock Fittings



Ringlock Fittings

Aluminum Vacuum Fittings available in sizes 4", 5", 6", 7", 8", 10", 12".

Steel Vacuum Fittings available in sizes 3", 4", 5", 6", 8", 10"

Cam & Groove Couplings

DA Coupler (Reducing)



Part #	Description
030-14032-848I	2" FQC x 3" MQC AL.
030-14048-832I	3" FQC x 2" MQC AL.
030-14048-864I	3" FQC x 4" MQC AL.
030-14064-832I	4" FQC x 2" QC AL.
030-14064-848I	4" FQC x 3" MQC AL.
030-14064-896I	4" FQC x 6" MQC AL.
030-14096-864I	6" FQC x 4" MQC AL.

WARNING: UNDER NO CIRCUMSTANCES should cam and groove couplings be used for compressed air or steam service!

Part A



SIZE in.	PART NO.
1 ½	030-01024-824CI
2	030-01032-832CI
3	030-01048-848CI
4	030-01064-864CI
6	030-01096-896CI

Part E



SIZE in.	PART NO.
1 ½	030-05024-824CI
2	030-05032-832CI
3	030-05048-848CI
4	030-05064-864CI
6	030-05096-896CI

Part B



SIZE in.	PART NO.
1 ½	030-02024-824CI
2	030-02032-832CI
3	030-02048-848CI
4	030-02064-864CI
6	030-02096-896CI

Part F



SIZE in.	PART NO.
1 ½	030-06024-824CI
2	030-06032-832CI
3	030-06048-848CI
4	030-06064-864CI
6	030-06096-896CI

Part C



SIZE in.	PART NO.
1 ½	030-03024-824CI
2	030-03032-832CI
3	030-03048-848CI
4	030-03064-864CI
6	030-03096-896CI

Dust Plug



SIZE in.	PART NO.
1 ½	030-08024-800CI
2	030-08032-800CI
3	030-08048-800CI
4	030-08064-800CI
6	030-08096-800CI

Part D



SIZE in.	PART NO.
1 ½	030-04024-824CI
2	030-04032-832CI
3	L030-04048-848CI
4	030-04064-864CI
6	030-04096-896CI

Dust Cap



SIZE in.	PART NO.
1 ½	030-07024-800CI
2	030-07032-800CI
3	030-07048-800CI
4	030-07064-800CI
6	030-07096-800CI

Cam & Groove Accessories

Cam & Groove Gaskets

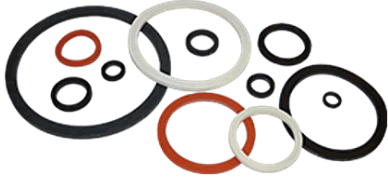

- Materials: Buna-N, FKM, Extra thick Buna-N, Ethylene Propylene, Neoprene, White Neoprene, White Buna-N, Silicone
- Sizes from 1/2" to 8"
- white neoprene & white Buna-N gaskets all contain FDA approved materials

Cam & Groove PTFE Gaskets



Envelope

- Materials: Available with Buna-N, FKM, white Buna-N or Ethylene Propylene fillers
- Sizes from 1/2" to 6"
- PTFE white Buna filler (TFWB) all contain FDA approved materials



Encapsulated

- Materials: Available with encapsulated silicone or encapsulated FKM
- Sizes from 3/4" to 4"
- PTFE encapsulated silicone (TES) all contain FDA approved materials



Accordion

- Materials: PTFE (TFE)
- Sizes from 3/4" to 3"
- PTFE accordion gaskets are recommended for use with viscous (thick) fluids only

Features:

- encapsulated gasket pressure ratings are reduced to 125 PSI for 3/4" - 4" at ambient temperature 70°F (21°C)
- PTFE encapsulated FKM (TEV) gaskets - maximum operating temperature 200°F (93°C)
- PTFE encapsulated silicone gaskets (TES) gaskets - maximum operating temperature 225°F (107°C)

Round Hole Strainer



- Materials: Zinc plated steel or 304 Stainless Steel
- Sizes: Zinc plated steel 1-1/2" to 12", 304 Stainless Steel 1-1/2" to 6"
- Thread: NPSM

Shank Hose Couplings

JGB Private Brand Water Shanks

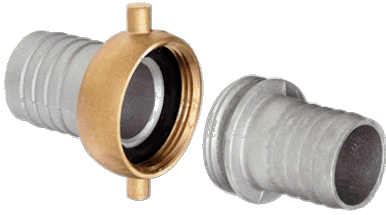

- Material: Aluminum with brass nut
- Rubber Seal
- Thread: NPSM
- Thread Sizes: 1" to 6"

Powerlock Clamps

Powerlock Clamp/Powerlock Clamp PS

The Powerlock clamp is a steel, double bolt clamp designed specifically for use with corrugated hose.



Powerlock ID in	Powerlock PS ID in	Torque lbs/ft
2	2	7.2
2 ½	3	7.2
3	4	9.4
4	-	14.5
5	-	14.5
6	-	16.6
8	-	16.6
10	-	18.1
12	-	18.1

Hose Menders

Steel Hose Mender



- Materials: Zinc plated steel or 316 Stainless Steel
- Sizes: Zinc plated steel 3/8" to 2-1/2", 304 Stainless Steel 3/8" to 1/2"

Hammer Unions

100 Series Forged Steel



Used on low pressure manifolds and lines and in applications running air, water, oil or gas up to 1,000 PSI NSCWP (non-shock cold working pressure).

Size (in)	Configuration	NSCWP	Part #
2	threaded 100 series	1000	039-HU100200
2	butt weld 100 series	1000	039-HU100200BW*
2 ½	threaded 100 series	1000	039-HU100250
3	threaded 100 series	1000	039-HU100300
4	threaded 100 series	1000	039-HU100400
4	butt weld 100 series	1000	039-HU100400BW*
6	threaded 100 series	1000	039-HU100600
8	threaded 100 series	1000	039-HU100800

* butt weld ends are schedule 80

200 Series Forged Steel



Used in general service applications running air, water, oil or gas up to 2,000 PSI NSCWP (non-shock cold working pressure).

Size (in)	Configuration	NSCWP	Part #
1	threaded 200 series	2000	039-HU200100I
1 ½	threaded 200 series	2000	039-HU200150
2	threaded 200 series	2000	039-HU200200
2	butt weld 200 series	2000	039-HU200200BW*
2 ½	threaded 200 series	2000	039-HU200250
3	threaded 200 series	2000	039-HU200300
4	threaded 200 series	2000	039-HU200400
6	threaded 200 series	2000	039-HU200600

* butt weld ends are schedule 80

Sandblast Hose Couplings

Aluminum Two Lug Hose Coupling



Part Number	Hose Size	Hose OD	Weight Each	Standard Carton
Q-AL050	1/2 in	1.06 in	0.15 lb	6
Q-AL1	3/4 in	1 1/2 in	0.36 lb	6
Q-AL2	1 in	1 7/8 in	0.36 lb	6
Q-AL3	1 1/4 in	2 5/32 in	0.66 lb	6
Q-AL4	1 1/2 in	2 3/8 in	0.88 lb	6
Q-AL5	1 1/2 in	2 3/8 in	1.10 lb	6

Aluminum Two Lug Female Threaded Coupling (NPT Threads)



Part Number	Hose Size	NPT Thread	Weight Each	Standard Carton
SB-AL1	1 1/4 in	1 1/4 in	0.34 lb	6
SB-AL2	1 1/2 in	1 1/2 in	0.28 lb	6
SB-AL3	1 1/2 in	1 1/2 in	1.05 lb	6

Aluminum Nozzle Holder (NPS Threads)



Part Number	Hose Size	Hose OD	NPS Thread Size	Weight	Standard Carton
NH-AL050	1/2 in	1 1/16 in	3/4 in	0.15 lb	6
NH-AL1	3/4 in	1 1/2 in	1 1/4 in	0.30 lb	6
NH-AL2	1 in	1 7/8 in	1 1/4 in	0.36 lb	6
NH-AL3	1 1/4 in	2 5/32 in	1 1/4 in	0.52 lb	6
NH-AL4	1 1/2 in	2 3/8 in	1 1/4 in	0.98 lb	6

Natural Rubber Gasket for Sandblast Couplings



Part Number	Weight Each	Standard Carton
SBG	0.032 lb	10
SRG-2	0.063 lb	10

Fire Hose Couplings



Hydrant Adapter Pin Lug Brass

- Material: Cast Brass (polished chrome finish available)
- NST(NH), NPSH, GHT, NYFD, or NYC threads
- 1-1/2" to 4-1/2" female thread sizes
- 3/4" to 3" male thread sizes



Brass Female to Male Hex Nipple

- Material: Cast Brass
- NST(NH), NPSH, GHT, NYFD, or NYC threads
- 3/4 to 6" male & female thread sizes



Brass Double Male Hex Nipple

- Material: Cast Brass
- NST(NH)/NST(NH), NST (NH)/NYFD, NYFD/NYFD, NPSH/NPSH, NPT/NPSH, NPT/NST, NPT/GHT, NPT/NPT, NPT/NYFD threads
- 3/4" to 6" / 1-1/2" to 6" male thread sizes



Domestic FM Approved Polycarbonate Fog Nozzle:

- Material: Polycarbonate
- NST(NH), NPSH, GHT threads
- 3/4" to 1-1/2" Sizes



Brass Industrial Fog Nozzle

- Material: Brass
- NST(NH), NPSH, GHT threads
- 3/4" to 2-1/2" Sizes
- 90° Spray GPM at 100 PSI =(from 32 to 205)



Plain Hose Nozzle

- Material: Brass with satin finish
- NST(NH), NPSH, GHT, NYFD threads
- 3/4" to 2-1/2" Sizes
- 90° Spray GPM at 100 PSI =(from 32 to 205)



Adjustable Hydrant Wrench

- Material: Aluminum
- Compact wrench easily carried in your jacket pocket
- Fits 3/4" to 3" rocker lug and pin lug couplings
- Weight: 4.21 lbs.



5 Hole Hydrant Wrench

- Material: Plated Iron
- 5 pentagon holes designed to fit common hydrant nut sizes
- Built-in spanner for pin or rocker lug couplings
- Weight: 2.05 lbs.
- Length: 14-1/4"

Hose Banding Tools (Center Punch)

Center Punch Clamp Tool



- The center punch tool will work with both 3/8" and 5/8" wide clamps.
- Part #: 039-HBC-300

Center Punch Clamp



- Band width: 3/8" & 5/8"
- Materials: 201 Stainless Steel or Galv. Carbon Steel
- Clamp IDs: 13/16" to 8"

Valves

6" Lever Gate Valve



- Materials: Bronze construction
- Double wedge gate design

6" Threaded Pipe x ANSI Flange



Assy #	Flange Dimensions				Weight
	OD	BC	Holes	Thickness	
SV966-MSM	11.00"	9.50"	8-.88"	.50"	40.0 lb

MSM=Steel Body with 316 Stainless Stem & Gates

Safety Cables

Evertite Hose End to Tool End



- Tube:** NBR/SBR, light oil resistant
- Reinforcement:** 2-1/2" - 4": 6 ply
6": 8 ply
High tensile textile cord
- Cover:** NR, Weather, Ozone, and Abrasion Resistance
- Temperature:** -22°F to +185°F
- Branding:** EAGLE WATER JETTING
- Couplings:** Contact JGB for proper fitting recommendation and coupling procedure.

Cable	Hose ID	Length	Part #
	in	in	
1/8	1/2 to 1-1/4	20	3TWHT1
1/4	1-1/2 to 3	38	3TWHT2

Dixon King Safety Cables

Style WSR - Style W

When hose, couplings or clamps fail, or there is an accidental separation of the assembly, King safety cables minimize damage to equipment and injuries to operators. King safety cable reaches across the hose fittings to provide standby safety for hose. Spring-loaded loops in the cable ends open easily to pass over the couplings for a firm grip on the hose. Thoroughly tested with years of service. A positive safeguard for air hose connections - helps you meet today's safety standards.



King safety cable must be installed in the extended position (no slack)

- Features**
- Hose-to-hose or hose-to-rigid outlet
 - King cable is the low cost answer to eliminate injuries caused by broken air hose connections
 - Highly resistant to rust and corrosion
 - No tools needed - Easy to install and remove
 - maximum working pressure: **200 PSI**

Style WSR, for hose-to-tool service

Hose ID	Cable	Length	Max. Work.	Steel	Stainless Steel
			Press. PSI	Part #	Part #
1/2" - 1-1/4"	1/8"	20-1/4"	200	WSR1	WSR1SS
1/2" - 2"	3/16"	28"	200	WSR3	---
1-1/2" - 3"	1/4"	38"	200	WSR2	WSR2SS
4"	3/8"	44"	200	WSR4	---

Style W, for hose-to-hose service

Hose ID	Cable	Length	Max. Work.	Steel	Stainless Steel
			Press. PSI	Part #	Part #
1/2" - 1-1/4"	1/8"	20-1/4"	200	WB1	WB1SS
1/2" - 2"	3/16"	28"	200	WB3	---
1-1/2" - 3"	1/4"	38-1/4"	200	WA2	WA2SS
4"	3/8"	200	200	WA4	---

Hose Safety Accessories

JGB Safety Cables

Used for hose to hose safety restraint.



Wire Rope: Galvanized Carbon Steel for strength and durability

Ferrules: Aluminum

Springs: Galvanized Carbon Steel

- Features**
- The low cost answer to eliminate injuries caused by broken air hose connections
 - Reaches across the hose fittings to provide standby safety for hose. Spring-loaded loops in the cable ends open easily to pass over the couplings for a firm grip on the hose.
 - Thoroughly tested with years of service. A positive safeguard for air hose connections- helps you meet today's safety standards.
 - Highly resistant to rust and corrosion

Part #	Size	Length	Hose ID	Max. WP	Weight
	in	in	in.	psi	lbs
025-0101-0000I	1/8	20-1/4	1/2 to 1-1/4	200	0.2150
025-0201-0000I	1/4	38	1-1/2 to 3	200	1.0600
025-0201-0001I	3/8	44	4	200	2.4500

Nylon Whipchecks

Specially designed choking action which allows the nylon to tighten down on the hose during a failure. Unlike the WHIP CHECK or the steel Hobble Clamp, the NYLON HOSE CHOKER will continue tightening down sometimes even choking off the air for a more controlled release.



NOTE: Double wrap the Nylon Choker on each end.

Part #	Breaking strength	Length: Loop to Loop	Recommended for Use on the Following Hose Inside Diameters using "Air"								
			1/4"	3/8"	1/2"	3/4"	1"	2"	3"	4"	6"
			Hose Maximum Internal Pressure PSI at Above Hose I.D.								
NC118	4000 lbs.	18"	26,000	12,000	6,500	3,000	1,700	-	-	-	-
NC124	4000 lbs.	24"	26,000	12,000	6,500	3,000	1,700	-	-	-	-
NC130	4000 lbs.	30"	26,000	12,000	6,500	3,000	1,700	-	-	-	-
NC136	4000 lbs.	36"	26,000	12,000	6,500	3,000	1,700	-	-	-	-
NC156	7000 lbs.	36"	-	-	-	-	-	725	325	175	-
NC180	7000 lbs.	36"	-	-	-	-	-	-	325	175	75
NC218	8000 lbs.	18"	40,000	15,000	13,000	6,000	3,350	825	-	-	-
NC224	8000 lbs.	24"	40,000	15,000	13,000	6,000	3,350	825	-	-	-
NC236	8000 lbs.	36"	-	-	-	-	3,350	825	375	200	-
NC248	8000 lbs.	48"	-	-	-	-	3,350	825	375	200	85
NC260	8000 lbs.	60"	-	-	-	-	-	825	375	200	85
NC344	18000lbs.	24"	-	-	-	-	10,000	2,500	1,250	700	-
NC364	18000lbs.	36"	-	-	-	-	-	2,500	1,250	700	300
NC444	23000lbs.	24"	-	-	-	-	12,000	3,000	1,500	800	-
NC464	23000lbs.	36"	-	-	-	-	-	3,000	1,500	800	400

All JGB literature is available for download at www.jgbhose.com



Industrial & Specialty Hose products by JGB Enterprises, Inc.

JGB Enterprises, Inc. offers JGB Private Brand hoses including ...

- Petroleum Hose
- Air Hose
- Hydraulic Hose
- Material Handling Hose
- Water Hose
- Specialty Hoses



Large Diameter Hose (LDH) Program by JGB Enterprises, Inc.

JGB Enterprises, Inc. offers every style of industrial hose, fittings, and hose assemblies to the commercial sector. JGB leads the industry in the manufacturing of custom hose assemblies, including large diameter hose (LDH). Whether your application involves...

- Standard sewer by-pass
- Well point jobs
- De-watering services
- Emergency response irrigation
- Flood zone

...we offer complete sales and service to develop the right assemblies for your application.



Industrial Rental Hoses, Fittings, & Assemblies by JGB Enterprises, Inc.

JGB is proud of the high quality hose, fittings, & hose assemblies that we offer to the contractor & "do-it-yourselfer". For over 30 years JGB has served the farm, rental, construction & municipality markets, by providing hose solutions to customers across the nation.

JGB stocks hose from manufacturers such as Gates, Kanaflex, Alfagomma, Kuriyama, Texcel, Continental ContiTech, Pacific Echo, Novaflex, Thermoid, and our own JGB Private Brand hose. We look forward to being your "hose and fittings connection".



Large Diameter Hose (LDH) LAY FLAT Water Transfer by JGB Enterprises, Inc.

The LDH, or Large Diameter Hose market, is one of the fastest growing markets in our industry, specifically in the energy exploration sector. With the addition of the Techmafex PES-500 Large Bore Hose Assembly Machine, we've expanded our production capabilities to meet the demand of these customers. JGB Enterprises is a one stop shop for all of your custom LDH Lay Flat hose assemblies.

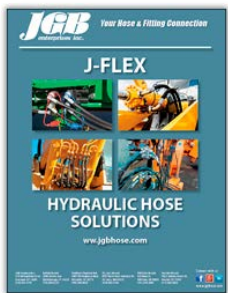

J-FLEX, Hydraulic Hose Solutions by JGB Enterprises, Inc.

JGB Enterprises, Inc. carries hydraulic hoses in the sizes, lengths & vacuum ratings for any low to high-pressure apparatus. Most of our hoses come with a choice of covers depending on usage conditions. Along with our bulk hose, JGB custom assembles hydraulic hose in many variations. We also carry hydraulic fittings, adapters, and couplers to work with any type of machine.

JGB enterprises inc.

Your Hose & Fitting Connection

Click for locations:



New England Region

115 Metropolitan Park Dr.
Liverpool, NY 13088
(315) 451-2770



Great Lakes Region

2540 Walden Ave. Suite 150
Cheektowaga, NY 14225
(716) 684-8224



Midwest Region

242 Carondelet Commons Blvd.
St. Louis, MO 63111
(314) 256-0833



Mid-Atlantic Region

1407 Westinghouse Blvd. Suite B
Charlotte, NC 28273
(704) 588-9920



Gulf Coast Region

619 E Sam Houston Pkwy. Suite 200
Pasadena, TX 77503
(281) 930-7777

Liverpool Location ISO 9001:2015 Certified QMS by Intertek

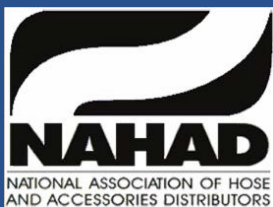

© July 2021 JGB® Enterprises, Inc. All Rights Reserved

Additional Resources:



JGB Eagle Brand
Master Catalog



Industrial Rental Catalog
Hoses, Fittings & Assemblies



Oilfield Catalog
Hoses, Fittings & Assemblies

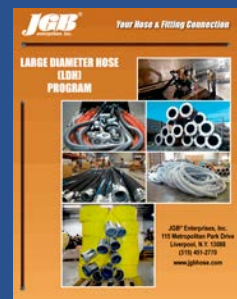

Large Diameter Hose
(LDH) Catalog

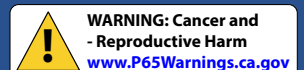

Connect with us:



www.jgbhose.com

Download the JGB Mobile App

